

MARSHALLTOWN, IOWA

ZONE ASSETS

- Emerson, the world leader in process control technology, has an administrative, production and R&D facility situated in the zone. Located near the zone are other global manufacturing firms such as Lennox.
- The historic Marshall County Courthouse is positioned on the town's square which provides convenient retail and services to the community.
- UnityPoint Health – Marshalltown has been a committed and involved partner of the Marshalltown community since its founding more than 100 years ago.



ZONE OPPORTUNITIES

- The community was impacted by a tornado in July 2018. Significant rebuilding efforts are under way. Tremendous real estate opportunities are available for single family, multi-family and commercial development.
- Vacant parcels for industrial development are located in the zone.



MARSHALLTOWN, IOWA

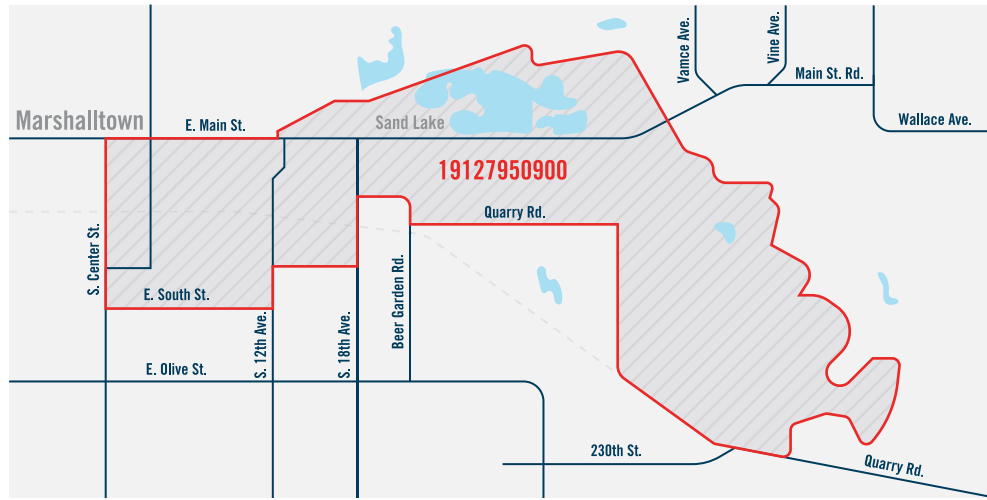

Census Tract #: 19127950900
Land Area (Square Miles): 4.84
Zip Code: 50158

Zone Typology: Commercial, Industrial, Residential, Mixed-Use

JOBS		
2010	2015	% CHANGE
6,081	6,405	+5.3%

RESIDENTS		
2010	2018	% CHANGE
3,307	3,476	+5.1%

Top 3 Industries:

1. Manufacturing
2. Wholesale Trade
3. Health Care and Social Assistance

Median Household Income:
\$43,830

Median Age:
32.7

Vacant Residential Properties:
 Number: 96
 Percentage: 6.9%

Local Incentives: Tax Increment Financing, Tax Increment Financing and Revolving Loan Fund

New Market Tax Credits: Yes

USDA Programs: Yes

For more information:

Thomas L. Deimerly | Executive Director
 Marshalltown Economic Development
 e: deimerly@marshalltown.org p: (641) 753-6645